



**BarnesBrinkcraft**  
Serving the Norfolk Broads since 1967

**WELCOME TO  
PRELUDE 4**

<b>THE BOATYARDS NAME IS</b>	<b>BARNES BRINKCRAFT RIVERSIDE ROAD WROXHAM NR12 8UD</b>
<b>BOATYARDS TELEPHONE NUMBER</b>	<b>01603 782625 – 8am to 5pm</b>
<b>AFTER HOURS TELEPHONE NUMBER</b>	<b>01603 782625</b>
<b>THIS BOAT IS NAMED</b>	<b>PRELUDE 4 (ELITE CLASS) 1634B</b>

TURNAROUND DAYS	SAT/TUES
LENGTH OF BOAT	46FT (14.02M)
WIDTH	12FT (3.66M)
STEERING	DUAL
BRIDGE CLEARANCE HEIGHT WITH SCREENS LOWERED	<b>8FT (2.43M)</b> <b>SCREENS / SIDES MUST BE LOWERED</b>
BRIDGE CLEARANCE	WILL NOT PASS UNDER WROXHAM BRIDGE, POTTER HEIGHAM BRIDGE, OR BECCLES OLD BRIDGE <b>Weather conditions and tide affect river levels so caution should be exercised at all bridges and please check the bridge clearance gauge carefully.</b>
BERTHS	5 DOUBLE BERTHS <u>OR</u> 3 DOUBLES and 4 SINGLE BERTHS IN 4 CABINS & SALOON
BED SIZES	SEE BOAT LAYOUT
HOW TO MAKE UP SALOON BED	DROP ELECTRIC TABLE LEVEL WITH SEATS AND USE LOOSE CUSHIONS TO MAKE BED
BATHROOM	2 BATHROOMS
HOW TO DRAIN SHOWER	DRAIN SWITCH IN SHOWER
COOKING FACILITIES	INDUCTION HOB MICROWAVE ELECTRIC OVEN
FRIDGE/FREEZER	2 X UNDER COUNTER FRIDGE WITH FREEZER BOX
BOW THRUSTER?	YES – BOW AND STERN
ELECTRIC ANCHOR WINCH?	YES
POWER	ELECTRIC
HEATER	INSTRUCTIONS INCLUDED IN YOUR MANUAL
NUMBER OF POWER SOCKETS	18
WIFI	YES ( UNLIMITED )
THE MAXIMUM NUMBER OF BERTHS FOR THIS BOAT IS	10 (8+2)
ADDITIONAL INFORMATION	<ul style="list-style-type: none"> <li>• SMART TV X 3</li> <li>• HAIR DRYER X 2</li> <li>• USB SOCKETS ON POWER PLUGS</li> <li>• BLUETOOTH SOUND SYSTEM</li> <li>• FUEL-EFFICIENT LOW EMISSION ENGINE, UTILISING SOLAR PANELS &amp; LATEST LITHIUM BATTERIES FOR A FASTER CHARGE</li> <li>• ADDITIONAL ROOF LIGHTS &amp; ELECTRIC SUNROOF FOR MORE INTERIOR LIGHT</li> <li>• FRAMELESS BONDED WINDOWS</li> <li>• <b>LICENSED FOR 11 PERSONS MAX IF USED AS A DAY BOAT DURING YOUR HIRE</b></li> </ul>

# BOAT LAYOUT

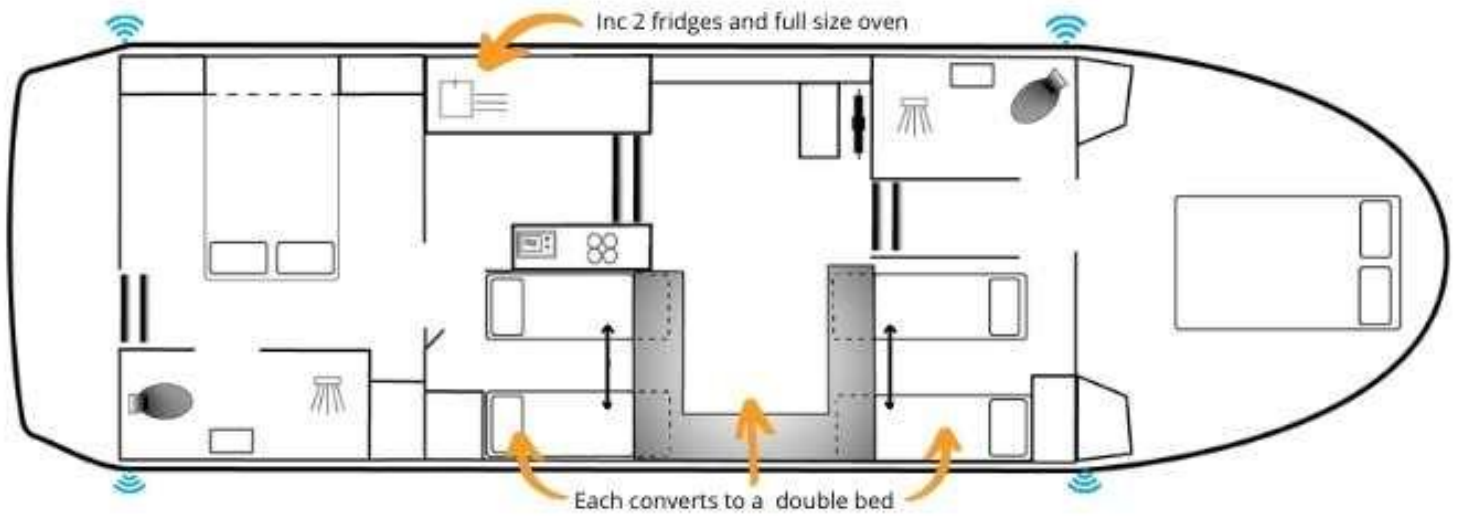

## WiFi

This boat is connected to our new unlimited WiFi. To connect to your onboard WiFi, you will need to go into your device's WiFi settings and select: "**BarnesBrinkcraft WiFi**"

You should then be taken to a login page that asks you to accept the Terms and Conditions

## How to work your heating system

Switch heating on via control panel in saloon.

Allow 10 minutes for the system to start and heat to come through.

If heater does not start after 10 minutes it may be that the temperature in the boat is higher than set.

Set the thermostat to maximum, and check the boat batteries are charged. If necessary, start engine to charge batteries.

If this does not work, please call the on-call engineer on 01603 782625.

When heater is switched off it will continue to run for up to 10 minutes while it cools itself down.

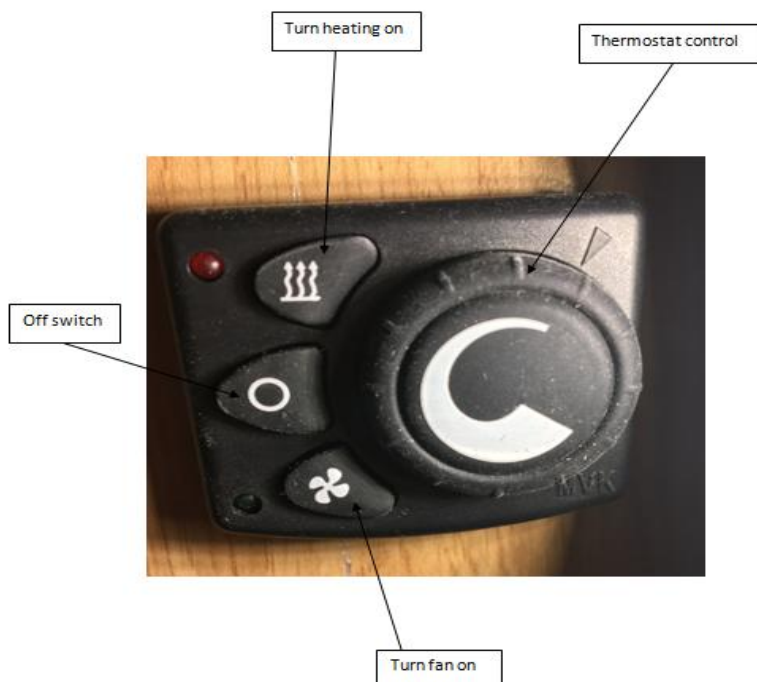

## How to operate your sunroof:



Firstly check the cover is removed from above the sunroof.

There is a black button above the Co2 / fire alarm. Push this button to open/close the sunroof.

## How to operate your bow and stern thrusters:



This is the control for your bow and stern thrusters.

To turn this on you need to push the 'on' button twice.

You can then move the lever at the top to either side for bow thrusters and the same at the bottom for stern thrusters.

# Throttle Controls

**This boat has upper and lower steering positions. Your boat will have the throttle controls pictured below in both positions.**

The throttle controls the speed of the boat. The further forward you push it the faster it will go and the further back you pull it the faster it will go in reverse.

## How to start your boat:

1. check your throttles is in neutral. If your boat has dual control check both throttles are in neutral. You can check this by making sure both the small triangle and notch on the inside on the throttle are lined up.
2. Put keys in ignition and turn to start the boat, both engine lights will come on. (The top two lights)
3. Press 'Command' on the controls you will be using (either upper or lower helm). You'll need to push the button for 1 second, and you will see the blue light come on above the command button.
4. The 'Warm/Sync' light will now be flashing. This means the gear control is disengaged.
5. Push the 'Warm/Sync' button (for 1 second) and the gear will be engaged. You can now drive the boat with the throttle.
6. Before untying and leaving the moorings test the throttle is working in forward and reverse by gently pushing the throttle slightly in both directions. Once you're confident the boat is responding to the throttle you can untie from the moorings and head off.

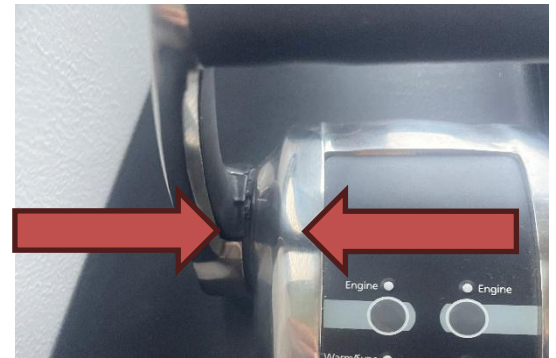

## Changing driving position:

1. When changing from one control to another you need to make sure BOTH throttles are in neutral (step 1 above)
2. Move to your desired driving position.
3. Hold the command button on the throttle for 1 second to engage, the light will come on when the command is engaged.
4. You can now control the boat from this driving position.

We recommend only changing controls/steering positions while the boat is moored. If you have just changed controls while moored, gently check forward and reverse gear at the control you wish to use are working correctly, before untying the boat and leaving the mooring.

Again, if you are not sure how to operate the boat or have any other concerns, please call our team (01603 782625).

## Prelude Drive System

The Prelude class cruiser is powered by a large battery driving the propeller with an electric motor. The battery can either be recharged by plugging into shore power or by running the onboard generator.

Plugging into shore power at any point will reduce the fuel used during your holiday. Most boatyards and some public moorings have some shore power sockets (often chargeable). If you cannot connect to shore power the engine / generator can be started at any time to recharge the battery. Please avoid running the generator while moored especially early or late in the day or at night.

We recommend the battery is kept above 50% charge while cruising. If the key is switched on and the battery reaches 50%, the generator will automatically start. Please note if the battery charge is below 50% the propeller power will be reduced. If the battery reaches less than 30% the power will be reduced even more. The power will return after the battery has been back above these levels for a while. We recommend starting the generator manually to control the battery level while underway. For example, if the battery reaches 55%, start the generator and then switch it off once the battery has recovered above 80% or more.

The boat also provides a little extra power while manoeuvring at low speed. Once the boat speed increases you may feel the power reduce slightly. The boat will run very quietly at low speed and use very little power. When running slowly the battery will run the boat for a few hours. The power required to drive the boat doubles with each extra mile per hour increase in speed. Try to avoid motoring into the tide. This will use more power and increase journey times.

When passing through Great Yarmouth try to make sure the battery is above 80% charged before starting your passage across Breydon Water. If it is low, consider topping it up before leaving. If you are using full power, start the generator and keep an eye on the charge level on the lower dash panel.

**Remember all power used on board must be replaced by burning fuel or connecting to shore power. Please also be aware that running the heaters will also burn fuel. Each heater uses up to 1 litre of fuel per hour.**

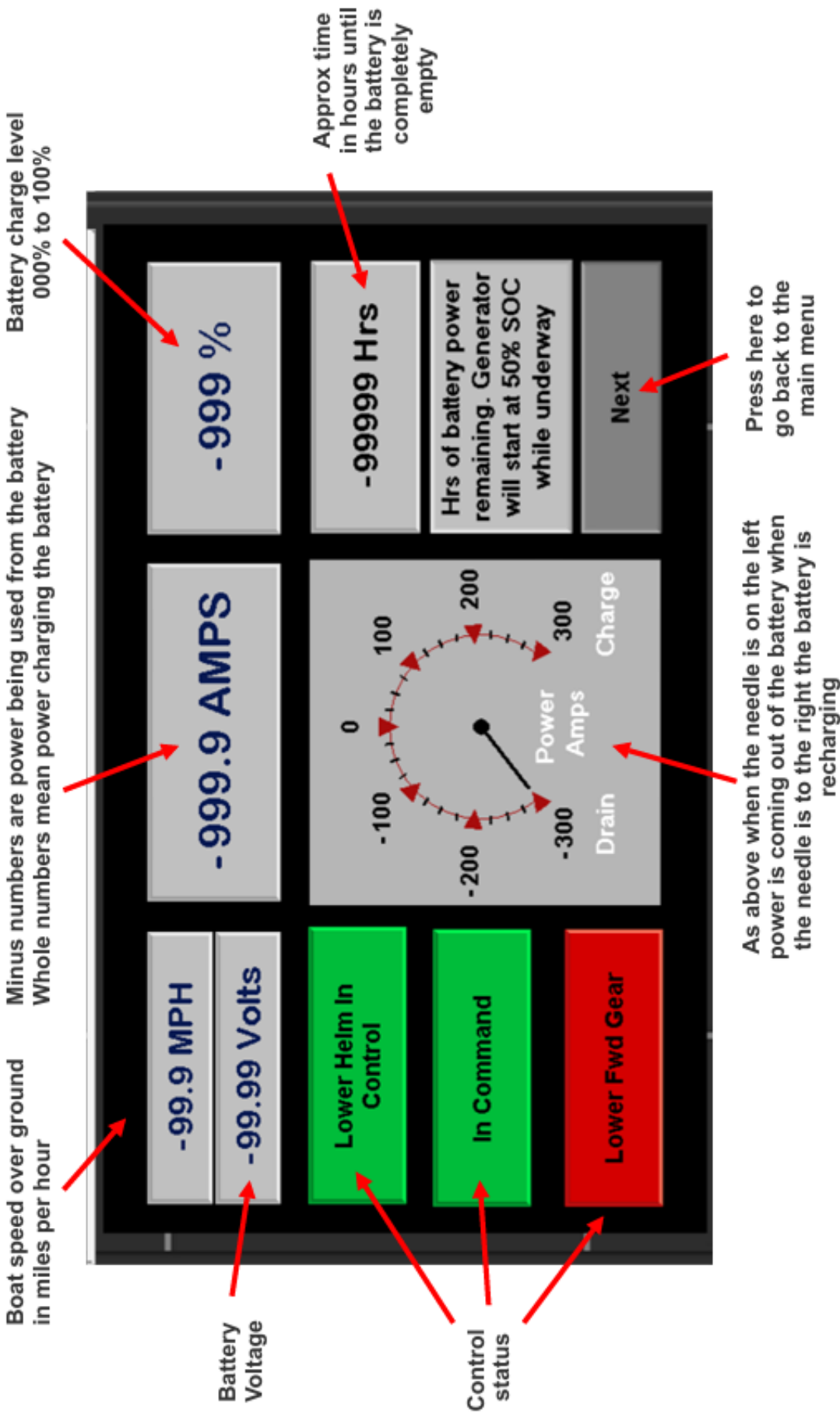

The motor control panel is on the lower helm dash. Use the AMPS display to keep an eye on power use when the boat is underway or you are cooking. The hours display will give you an idea of how long the battery will last at the current rate of use. Driving the boat and cooking use the most battery power.

## Prelude – Fuel and Water Tanks, Hot Water

Tank levels can be seen on the display on the upper helm position.

The fuel and water tank levels are shown in litres remaining. Due to the shape of the tank and level sensors used, the first 10-30 litres do not always seem to be read by the gauge. So please do not allow the fuel tank to drop below 20 litres. The fuel tank holds approximately 235 litres.

The water tank holds approximately 420 litres. Normally we would expect this to be topped up every day. If you do run out of water, switch off the water pump on the dash panel until the water has been refilled. You will need water in the tank to flush the toilets as well.

Hot water is heated by running the engine. This is the most energy efficient method as it uses the waste heat from the engine. If you need to heat the water while moored and the battery is over 50% charged, the immersion can be switched on at the generator panel. **The immersion will use a lot of battery power.** Because of the high power use it is switched off automatically after 1 hour.

The toilets both have their own holding tanks. They are shown on the upper display and read 0-100%. Again, very low levels and the last space above 100% are not read. We recommend a pump out mid-week, but if the gauges are reading low and with careful use of the toilets some people do manage a week without pumping out the tanks.

# Generator

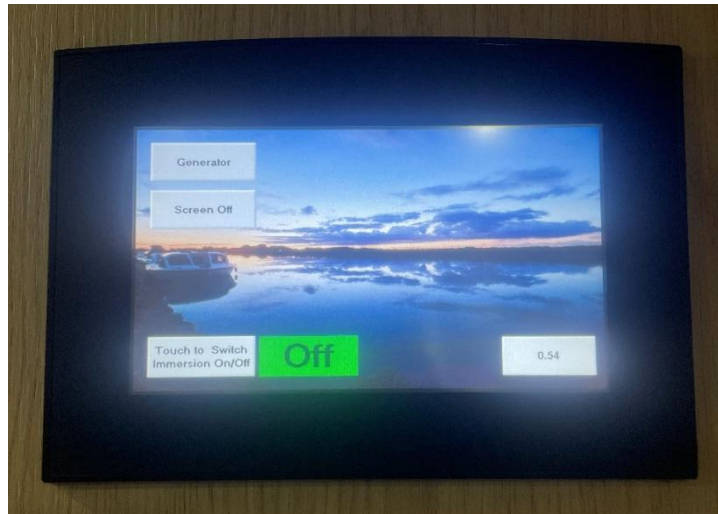

This screen in the Galley has your generator and immersion control on. The generator control panel is mounted in the galley beside the microwave. Touch the start button when the battery needs charging. The generator will start and slowly rev up until it reaches the maximum charge the battery can accept. Press the stop button once the battery has reached the required charge level.

You can also turn on and off your immersion here for hot water.

