



**BarnesBrinkcraft**  
Serving the Norfolk Broads since 1967

WELCOME TO  
DUET 5

# BOAT INFORMATION

THE BOATYARDS NAME IS	BARNES BRINKCRAFT in WROXHAM
BOATYARDS TELEPHONE NUMBER	01603 782625 – 8am to 5pm
AFTER HOURS TELEPHONE NUMBER	01603 782625 – option one
THIS BOAT IS NAMED	DUJET 5 (MID-RANGE CLASS)
TURNAROUND DAYS	SAT/TUES
LENGTH OF BOAT	29FT (9M)
WIDTH	10FT 6IN (3.20M)
STEERING	SINGLE
BRIDGE CLEARANCE HEIGHT WITH SCREENS UP	8FT 4IN
BRIDGE CLEARANCE HEIGHT WITH SCREENS LOWERED	N/A
BRIDGE CLEARANCE	WILL NOT PASS UNDER WROXHAM BRIDGE POTTER HEIGHAM BRIDGE BECCLES OLD BRIDGE
BERTHS	1 DOUBLE & 1 SINGLE IN <u>1 CABIN</u> & SALOON

<b>BED SIZES</b>	<b>SEE BOAT LAYOUT</b>
<b>HOW TO MAKE UP SALOON BED</b>	<b>PULL TABLE BACK, PULL BED OUT FROM SALOON</b>
<b>BATHROOM</b>	<b>1 BATHROOM WITH TOILET/SHOWER</b>
<b>HOW TO DRAIN SHOWER</b>	<b>SELF-DRAINING</b>
<b>COOKING FACILITIES</b>	<b>GAS 2 RING OVEN AND GRILL</b>
<b>FRIDGE/FREEZER</b>	<b>SMALL FRIDGE WITH ICEBOX</b>
<b>BOW THRUSTER?</b>	<b>NO</b>
<b>ELECTRIC ANCHOR WINCH?</b>	<b>NO</b>
<b>POWER</b>	<b>LIMITED 240v POWER  SHORE INVERTER 1600w SOLAR</b>
<b>HEATER</b>	<b>HEATER RUNS OFF THE DIESEL FANS RUN OFF THE ELECTRIC  INSTRUCTIONS INCLUDED IN YOUR MANUAL</b>
<b>NUMBER OF POWER SOCKETS</b>	<b>2</b>

WIFI	NO
THE MAXIMUM NUMBER OF BERTHS FOR THIS BOAT IS	3 (2+1)
ADDITIONAL INFORMATION	<ul style="list-style-type: none"><li>• RAISED STEERING POSITION WITH LARGE CUSHIONED COCKPIT</li><li>• DVD PLAYER</li><li>• OPENING PATIO DOORS WHICH CREATE</li><li>• OPEN LIVING SPACE WITH REAR SUN DECK</li><li>• EASY TO BOARD FROM THE REAR</li><li>• HAIR DRYER</li><li>• LICENSED FOR 6 PERSONS MAX IF USED AS A DAY BOAT DURING YOUR HIRE</li></ul>

# HEATING CONTROL

YOUR BOAT IS EQUIPPED WITH THIS HEATING CONTROL.

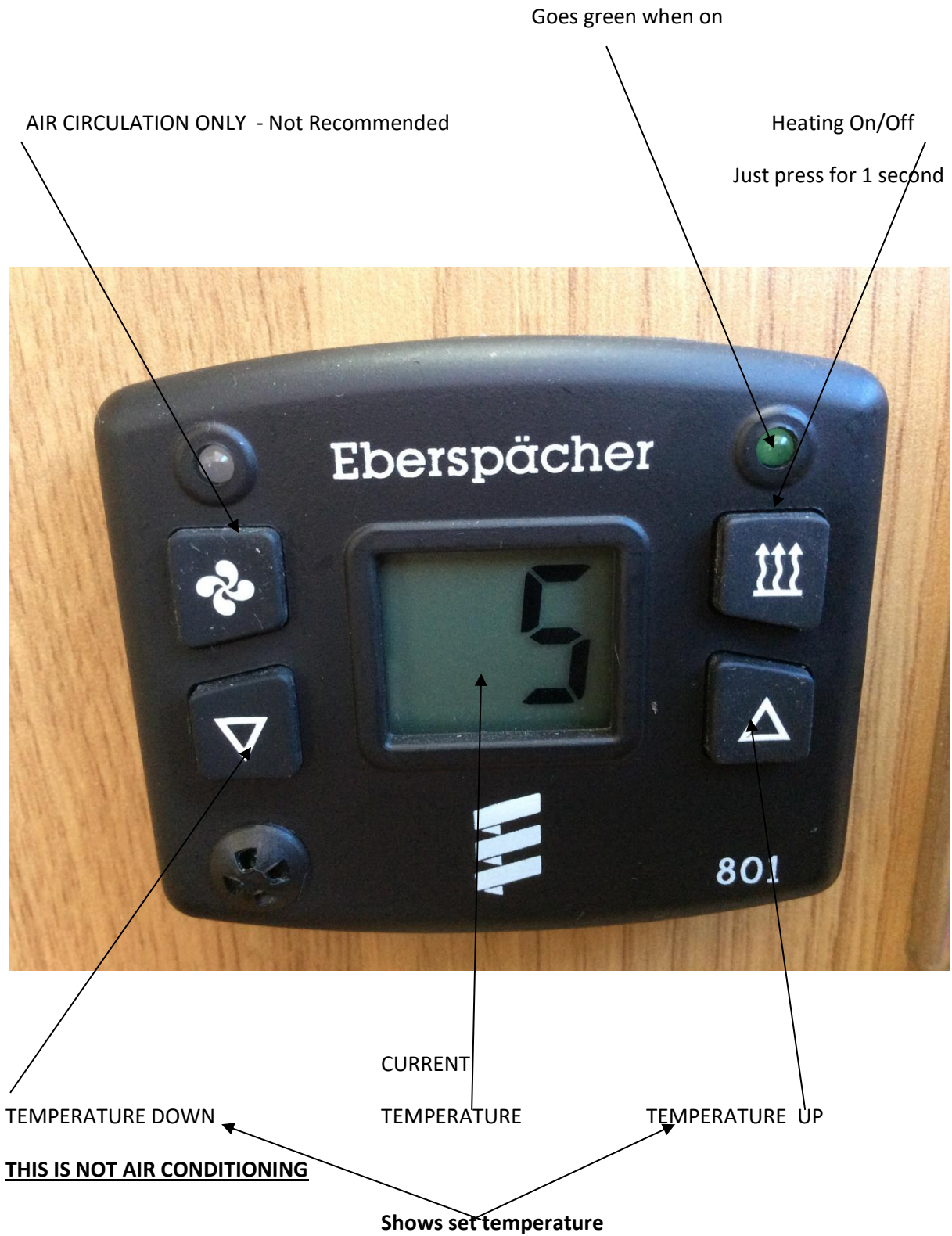

## How to work your heating system

Switch heating on as shown on opposite page.

Allow 10 minutes for the system to start and heat to come through.

If heater does not start after 10 minutes it may be that the temperature in the boat is higher than set.

Set the temperature to maximum, and check the boat batteries are charged. If necessary start engine to charge batteries.

If this does not work please call the on call engineer. 01603 782625 option 3

When heater is switched off it will continue to run for up to 10 minutes while it cools itself down.

## **Gas System Operation**

The cooker on this boat burns Liquefied Petroleum Gas (LPG). The gas comes from one or two cylinders located in a locker outside the boat. The gas has taps to isolate the gas on the top of the bottles, at an isolator tap in the galley and on the cooker.

1. To light the cooker, check that the connected bottle in the gas locker is switched on. All gas valves turn anti-clockwise for on.
2. The cooker isolator tap in the galley also needs to be on. Check the position against the label next to it.
3. To light the cooker first press the ignition button **OR** hold a lit match next to the selected burner.
4. Turn the tap anti-clockwise and hold it in to light the ring. Hold the tap in for a few more seconds and release it.
5. If the ring goes out when you release the tap you may need to repeat 3 & 4 and hold it in a little longer.
6. Make sure the cooker is switched off and the flame is out when you have finished.
7. For added safety switch of the gas cylinders in the locker.

### **What to do if you smell gas:**

- 1. Switch of the gas cylinders in the gas locker.**
- 2. Contact the boat yard on 01603 782625 and speak to an on call engineer.**
- 3. Open doors and windows to ventilate the boat if it is safe to do so.**

### **Do's and Don'ts**

**Do** make sure you are happy with the operation of the gas system during your trial run.

**Do** make sure the cooker is correctly turn off and isolated when not in use.

**Do** open a window or door when the cooker is in use to provide extra ventilation.

**Do** contact the boat yard if you have any concerns about the gas system and or ventilation.

**Do not** use any other fuel burning appliances that are not supplied with the boat. For example do not use gas cooking appliances, generators or barbeques onboard, if in doubt contact the boat yard for further advice.

**Do not** leave the cooker on unattended.

**Do not** use the cooker when underway. The movement of the boat could cause hot pans to spill or be knocked over.

**Do not** block any air vents even if there are drafts.

**Do not** Use the gas cooker to heat the boat.

# Duet

Fri/Mon (2+4) or Sat/Tues (3+5) start – 1 double & 1 single in 1 cabin & saloon -  
1 toilet/shower in 1 bathroom

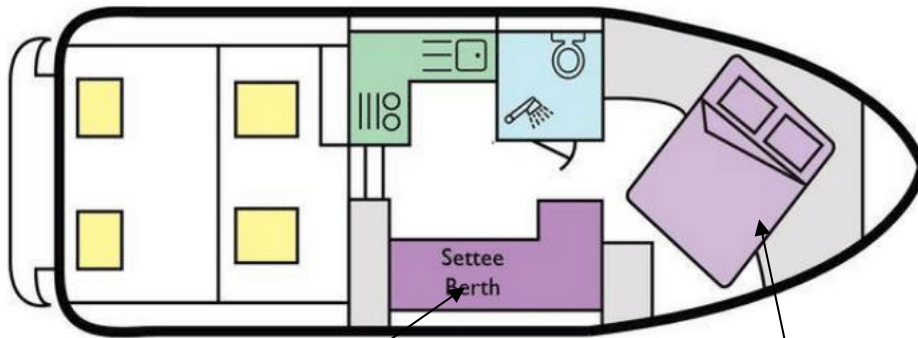

Drop table and pull bed out  
6ft 2 in x 3ft 5 in

6ft 2in x 5ft  
(dropping to 3ft 9in at bottom of  
bed)